

# SEMI-ELLIPSOIDAL DISHED HEADS | TYPE E

Øe mm	H mm	R mm	r mm	h* mm	S mm	V* mm	P** kg/mm
102	58	81.6	15.7	31	3-5	0.3	0.2
121	58	96.8	18.6	26	3	0.5	0.2
150	6	120	23	21	3	0.7	0.3
170	68	136	26.2	24	3	1.1	0.3
194	75	155.2	29.8	25	4	1.6	0.4
200	70	160	30.8	18	3	1.5	0.4
214	73	171.2	32.9	17	3	1.8	0.5
220	85	176	33.8	28	2.5-3	2.3	0.6
244	85	195.2	37.5	22	2.5-3	2.7	0.6
250	75	200	38.5	10	3	2.4	0.6
250	88	200	38.5	23	4-5	3	0.7
265	100	212	40.8	31	2-3	3.9	0.8
270	90	216	41.5	20	2-3	3.5	0.7
285	100	228	43.8	26	2.5-3	4.5	0.9
300	110	240	46.2	33	2.5-4	5.5	1
315	110	252	48.5	29	2.5-3	6	1.1
320	115	256	49.2	32	2.5-3	6.6	1.1
350	120	280	53.8	30	2.5-6	8.1	1.3
355	120	284	54.6	29	5-6	8.3	1.3
360	120	288	55.4	27	2.5-4	8.5	1.3
380	130	304	58.5	32	3-4	10.4	1.5
400	140	320	61.5	37	1.5-5	12.5	1.7
430	140	344	66.2	29	3-4	14.1	1.9
450	150	360	69.2	34	1.5-4	16.8	2.1
480	160	384	73.8	37	2-5	20.4	2.4
500	165	400	76.9	37	2-5	22.8	2.6
530	175	424	81.5	39	2.5-4	27.3	2.9
550	175	440	84.6	34	2-5	29	3
580	185	464	89.2	36	2.5-4	34.2	3.3
600	190	480	92.3	36	2.5-6	37.5	3.6
630	190	504	96.9	29	3-5	40.5	3.8
650	200	520	100	34	2-5	45.9	4.1
700	210	560	107.7	31	3-5	55.4	4.7
750	230	600	115.4	38	2.5-6	70.4	5.4
790	230	632	121.5	28	3-5	76.5	5.8
800	240	640	123.1	35	2-4.5	83	6.1
800	240	635	141	25	5-7	82.2	6.1
850	260	650	146	32	2.5-5	101.8	6.9
900	270	720	138.5	40	3-5	118.5	7.7
950	280	760	146.2	37	2.5-5	139.4	8.5
1000	310	790	175	41	3-7	168.9	9.7
1100	300	880	169.2	19	3-6	189.2	10.7
1200	390	900	193	67	3-7	307.8	14.3
1250	350	1000	192	31	3-6	289.4	14.2
1500	410	1200	230	27	4-6	482	21
1600	440	1280	246	32	4-5	571	23

## TYPES OF ACHIEVABLE EDGES

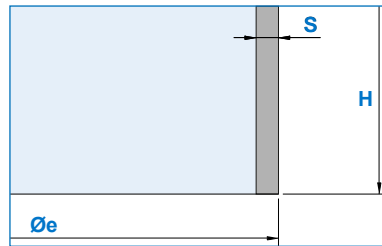

B1  
TRIMMED

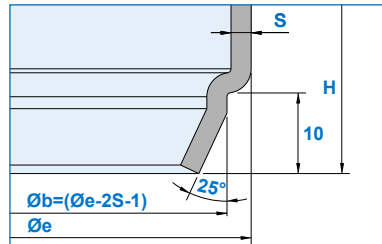

B3  
EDGED  
S ≤ 3mm

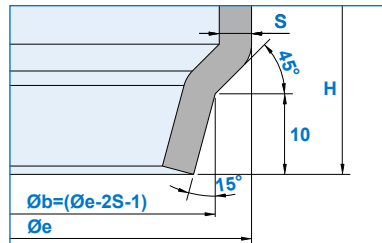

B4  
EDGED  
S > 3mm

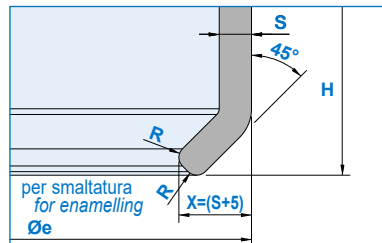

B6  
EDGED 45°  
FOR ENAMELLING

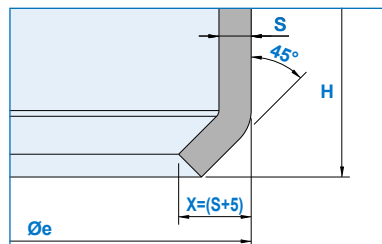

B7  
EDGED 45°

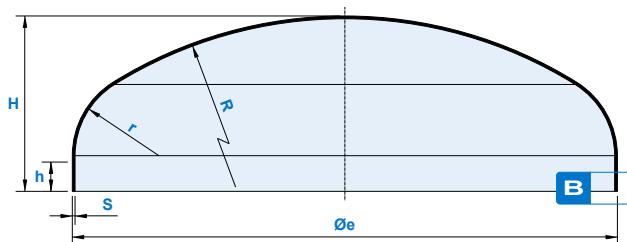

$R = 0,8 \times \text{Øe}$  ;  $r = \text{Øe} / 6,5$  (Radius DIN28013)

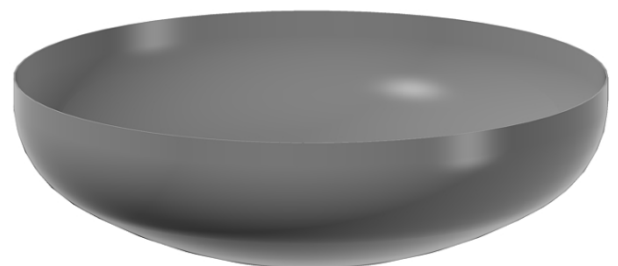

\* the dimension h and the capacity V have been calculated for trimmed dish heads with S = 3mm | \*\*the theoretical weight indicated is to be multiplied by the thickness in mm



Zapè srl

Via del Perlar 98 • 37135 Verona VR • Italy

w. www.zape.it • t. +39 045 500855 • e. info@zape.it