

DISHED HEADS FOR PIPES | SPECIAL TYPE

\varnothing_e mm	H mm	R mm	r mm	h* mm	S mm	V* mm	P** kg/mm
76	36	40	15	8	4 - 5	0.09	0.07
89	46	55	15	18	4 - 5	0.18	0.11
108	48	63	14	14	4 - 5	0.27	0.13
133	58	88	25	17	4 - 5	0.53	0.21
159	62	130	25	20	4 - 5	0.85	0.29
168	68	120	30	1	4 - 5	0.65	0.25
170	41	170	2	16	1.5 - 2.5	0.58	0.25
188	80	150	35	28	2.5	1.59	0.43
194	75	155.2	29.8	25	3 - 4	1.55	0.43
194	80	150	35	30	5	1.67	0.44
219	80	155	40	16	4 - 6	1.99	0.5
244	93	190	40	28	4 - 6	3.06	0.67
273	100	210	50	23	4 - 6	4.06	0.8
324	120	270	60	32	4 - 6	7.13	1.17
368	116	300	55	23	4 - 6	8.47	1.33
430	155	380	65	51	4 - 5	16.75	2.07

TYPES OF ACHIEVABLE EDGES

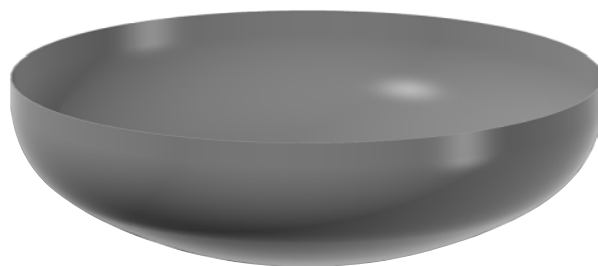
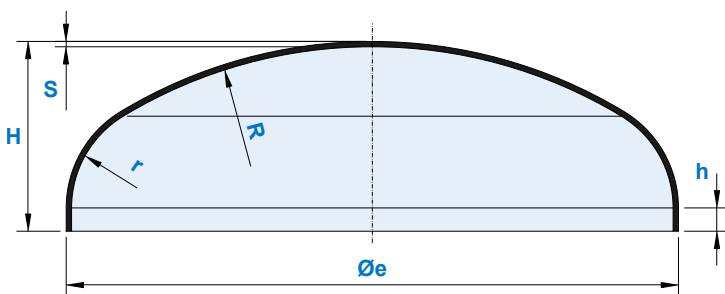
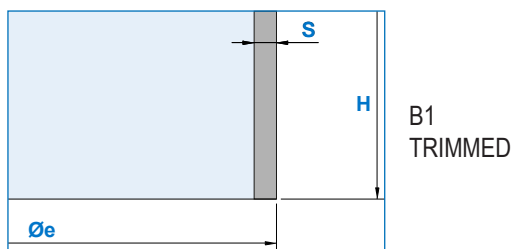

* the dimension h and the capacity V have been calculated for trimmed dished heads with S = 3mm | **the theoretical weight indicated is to be multiplied by the thickness in mm



Zapè srl

Via del Perlar 98 • 37135 Verona VR • Italy

w. www.zape.it • t. +39 045 500855 • e. info@zape.it